

AVENTUS Semi-Custom Split DOAS for a Middle School

MARKET: School

This AVENTUS by Xetex project showcases an outdoor semi-custom split-DOAS unit for a middle school. An enthalpic flat plate cross flow heat exchanger provides energy efficiency. Designed for all-season climate control, heating and cooling coils help keep students and staff comfortable. High-efficiency filters (OA/RA) capture airborne particles for indoor air quality.

CONSTRUCTION

- Outdoor unit with **thermal break** construction
- 2" double wall casing and injected foam (R-14) insulation
- 20ga galvanized metal exterior casing with acrylic paint
- 20ga galvanized metal interior casing
- Welded 6" structural steel base with lifting lugs and acrylic paint
- 16ga galvanized steel floor with 2" injected foam (R-14) insulation

Model:	AVT-DA-29.5-36-RT-BP-CW-HW-RC
Dimensions:	63"H x 190"L x 63"W
Weight:	3,750 lbs
Supply CFM:	1,700 CFM
Energy Recovery:	Enthalpic Crossflow Plate
Energy Effectiveness:	Winter: 68% / Summer: 64%
Heating Type:	Hot Water Coil
Heating Capacity:	103 MBH
Cooling Type:	Chilled Water Coil
Cooling Capacity:	65 MBH

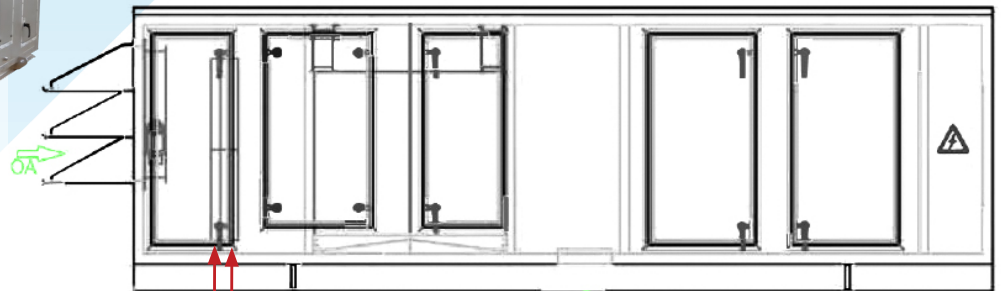

FEATURES

- GFCI outlet
- LED service lights
- Double-sloped foam insulated 304 SS drain pan
- Fiberglass floor grates in all floor duct openings
- SA/EA EC motors

COMPONENTS

- A. OA 2" MERV 8 filters
- B. OA 4" MERV 13 filters
- C. Bypass damper
- D. Enthalpic crossflow plate heat exchanger
- E. SA fan
- F. Chilled water cooling coil
- G. Hot water coil
- H. RA 2" MERV 8 filters
- I. Recirculation damper
- J. EA fan

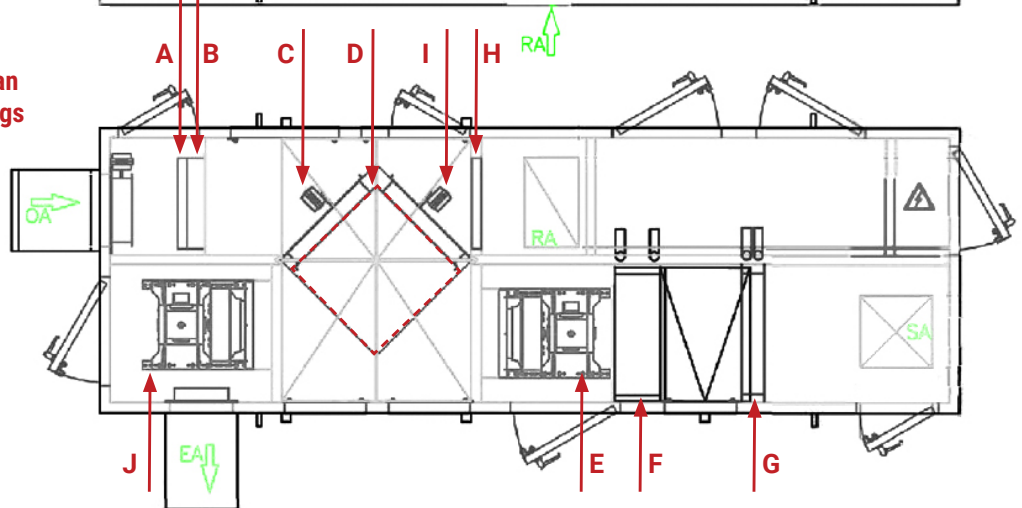

Contact Xetex for your next AVENTUS Semi-Custom Split DOAS or ERV!

Xetex.com/AVENTUS