

Indoor ERU with Enthalpic Wheel, Sound Dampening Design and 18K CFM

MARKET: School

This XeteX custom indoor energy recovery unit (ERU) is one of five units designed for an academic complex. Features include an energy efficient enthalpic wheel with recirculation damper; motor removeable I-beams; SA/EA premium six-fan arrays with perforated liner sections; fan back draft dampers; high efficiency filters in the OA/RA; and chilled water and hot water coils. This high performance unit delivers energy efficient climate control, indoor air quality, quiet operation, and wash-down capabilities.

CONSTRUCTION

- Indoor unit manufactured with **three unit sections**
- **Thermal break construction** with 2" double wall casing and injected foam (R-value 14) insulation; 20ga galvaneal steel outer casing with acrylic paint; 18ga galvanized steel interior casing
- 0.080 aluminum floor with 2" injected foam (R-value 14) insulation
- Welded 8" steel base frame with extended frame lifting lugs and acrylic paint

FEATURES

- **3Å desiccant wheel (8" deep) with low cross-contaminating seal system**
- **20ga perforated liner for sound dampening in SA & EA fan sections**
- **Aluminum tread plate floor with a 2" upturn lip and a drain connection in each section for wash-down capabilities**
- **Motor removal I-beams** for SA and EA fans
- SA and EA fan back draft dampers
- IP 65 rated unit LED lights and GFI
- 25 kAIC
- Test ports provided on all access doors

COMPONENTS

- A. OA 2" MERV 8
- B. OA 12" MERV 14
- C. Enthalpic energy wheel
- D. Hot water coil
- E. Chilled water coil with SS casing
- F. SA back draft damper
- G. SA six premium plenum fan array
- H. SA fan motor removable I-beam
- I. RA 2" MERV 8
- J. Recirc damper
- K. EA back draft damper
- L. EA six premium plenum fan array
- M. EA fan motor removable I-beam

Model:	AVR-2600-CW-HW-FF-RC
Dimensions:	120"H x 325"L x 157"W
Weight:	25,000 lbs
Supply CFM:	18,164 CFM
Heating Type:	Hot Water Coil
Heating Capacity:	1,154 MBH
Cooling Type:	Chilled Water Coil
Cooling Capacity:	706 MBH
Energy Recovery:	Enthalpic Energy Wheel
Energy Effectiveness:	Winter: 73% / Summer: 74%

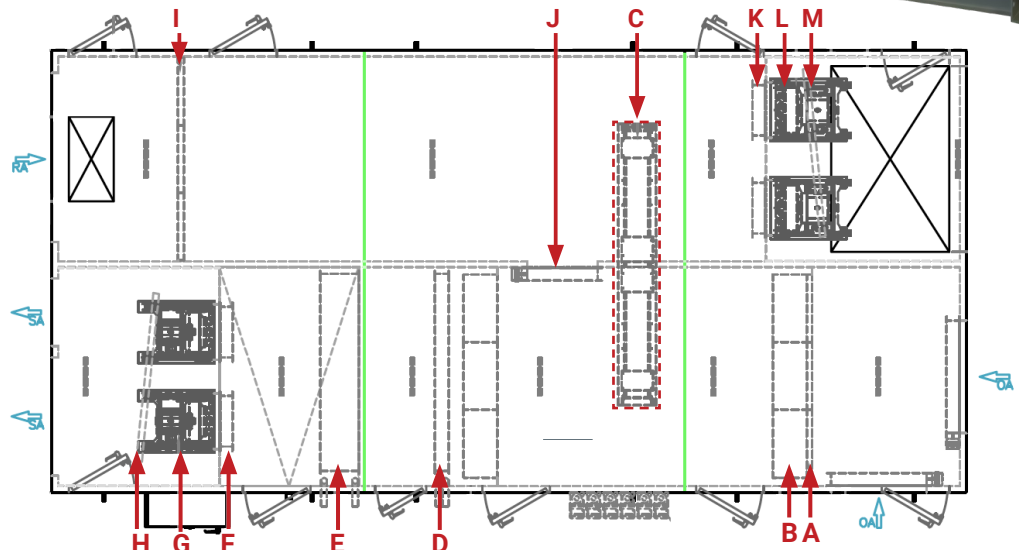

Contact XeteX for your next Custom ERU or AHU!

XeteX.com