

### FEATURED UNIT: DOAS with Coated HX and Explosion Proof EA Motor

#### MARKET: Waste Water Treatment Plant

This XeteX project features a custom heat recovery ventilator for a waste water treatment plant located at one of the most exclusive lifestyle estates in the world. The facility repurposes treated water to make snow for the ski slopes and water the golf course greens.

This custom unit features an aluminum, epoxy-coated flat plate heat exchanger that offers energy recovery as well as no cross contamination. Premium MERV filtration at the OA and RA improve indoor air quality. The exhaust air fan includes an explosion-proof motor for safety and non-corrosive material has been selected for long life.



<b>Model:</b>	XHS-40(20)-72-RT-HI-BP
<b>Height:</b>	88 in
<b>Width:</b>	102 in
<b>Length:</b>	224 in
<b>Weight:</b>	9,100 lbs
<b>Energy Recovery:</b>	Flat Plate Heat Exchanger
<b>Effectiveness:</b>	85% Winter / 62% Summer
<b>Supply CFM:</b>	8,000 CFM
<b>Heating Equipment:</b>	Indirect Gas Fired Furnace
<b>Heating Capacity:</b>	1,033 MBH

#### Construction

- Outdoor unit with double wall non-thermal break construction: 18ga galvaneal exterior casing with XeteX gray acrylic; 22ga galvanized steel interior casing with 2" fiberglass insulation
- Inner casing is 304 SS at the exhaust section

#### Components

- A. 2" MERV 8 OA with galvanized rack**
- B. Epoxy-coated aluminum flat plate heat exchanger**
- C. The explosion-proof EA motor with 304 SS plenum and an aluminum fan impeller**
- D. 2" MERV 8 RA with SS rack**
- E. 409 SS indirect gas fired furnace**

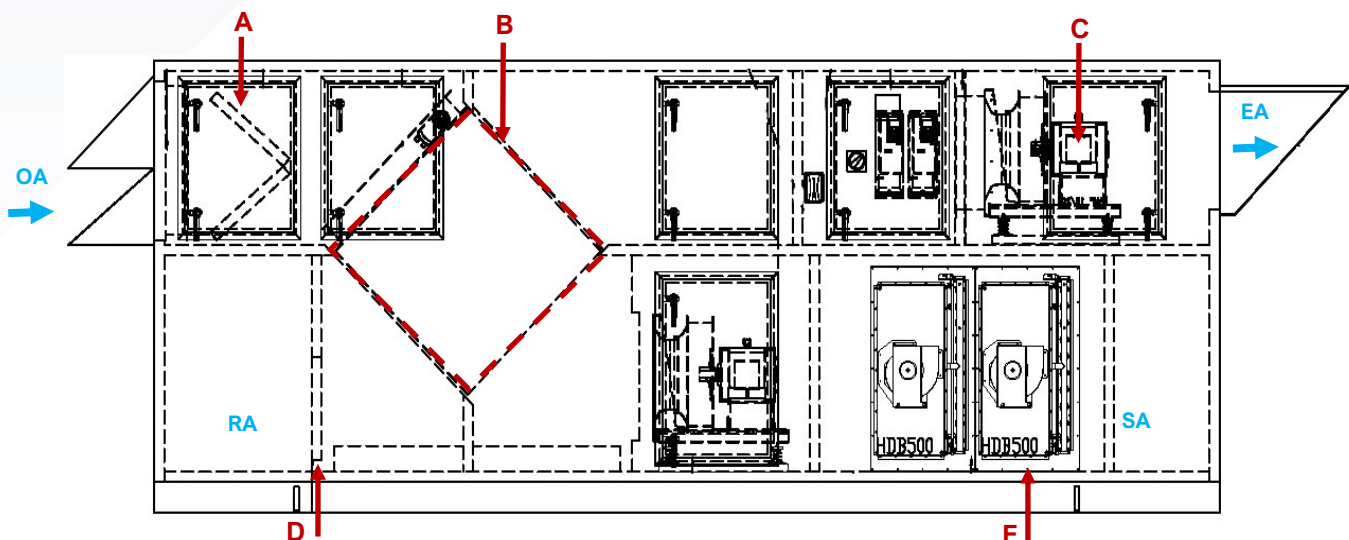

**Contact XeteX for your next Custom DOAS!**

xetex.com